

Rialto House, Fishergate, York

2022-2023 excavations

Research questions, environmental
sampling and initial findings

Rialto House, Fishergate: Development

 York
Archaeology

OLYMPIAN

 GMI Construction
Group PLC



Rialto House, Fishergate: Impact

Managing the impact of the development on archaeological deposits:

- Desk based assessment
- Archaeological evaluation and borehole monitoring informed a site deposit model
- Archaeological Remains Management Plan
- Adapting foundation plan of development to limit the impact
- Mapping features below formation level

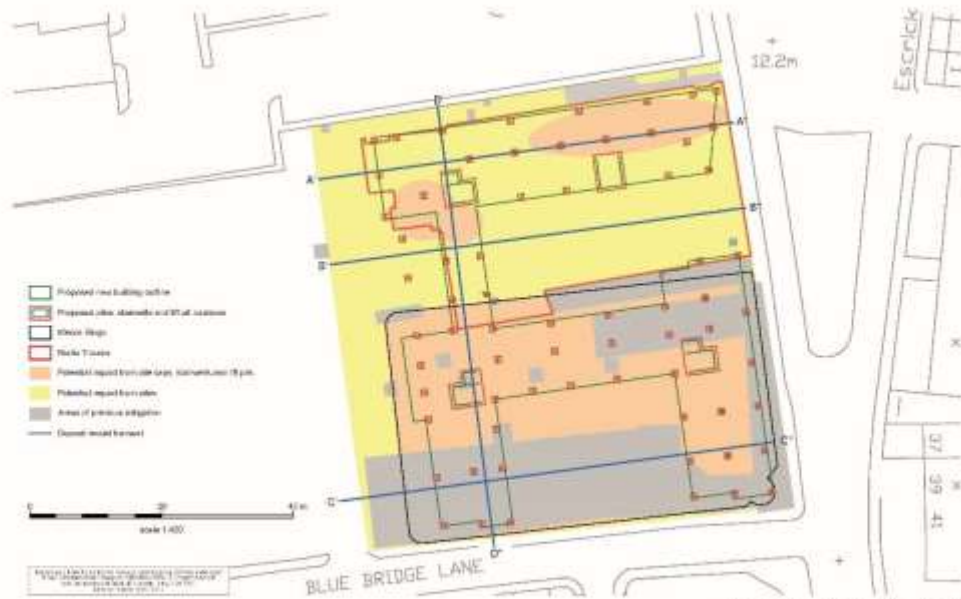

Figure 2 Proposed foundation design with archaeological risk

York Archaeological Trust

Rialto House, Fishergate: Excavations



September – December 2022



September – December 2023

Rialto House, Fishergate: Challenges & Opportunities



Challenges:

- Terrible, terrible weather
- Time constraints
- Excavating large archaeological features safely

Opportunities:

- Employing a range of on site techniques to add to our understanding of the area
- Environmental sampling
- Outreach opportunity



Rialto House, Fishergate: Research Questions

Prehistoric

Roman - AD 43-410

Anglian - AD 410-876

Anglo-Scandinavian -
AD 876 -1066

Medieval - 1066 - 1485

Post medieval & Modern
- AD 1485 - present



The Environmental Archaeology

An overview of sample types, materials and techniques
By Charlotte Lucy Molloy and Dr Paul Flintoft



Environmental Archaeology: Sample types



- Bulk soil samples
- Pollen
- Cess

Environmental Archaeology: Ecofacts – Flora



Waterlogged hazelnut shell and bramble seeds



Discus rotundatus, a shade loving terrestrial mollusc species

Environmental Archaeology: Ecofacts – Fauna



Discus rotundatus, a shade loving terrestrial mollusc species

- Large animal bones
- Microfauna
- Terrestrial mollusc
- Marine mollusc



Environmental Archaeology: Scientific Techniques

- aDNA
- NPPs
- Isotopes
- ZooMS



Environmental Sampling: Potential and Significance

What sort of research questions can the environmental archaeology answer?



Carbonised wheat grains from a Rialto House sample



Rialto House, Fishergate: Initial Results



- Excavation of archaeological remains impacted by development
- Mapping of remains to be left in situ

Initial Results: Site Plan - North



Initial Results: Site Plan – South

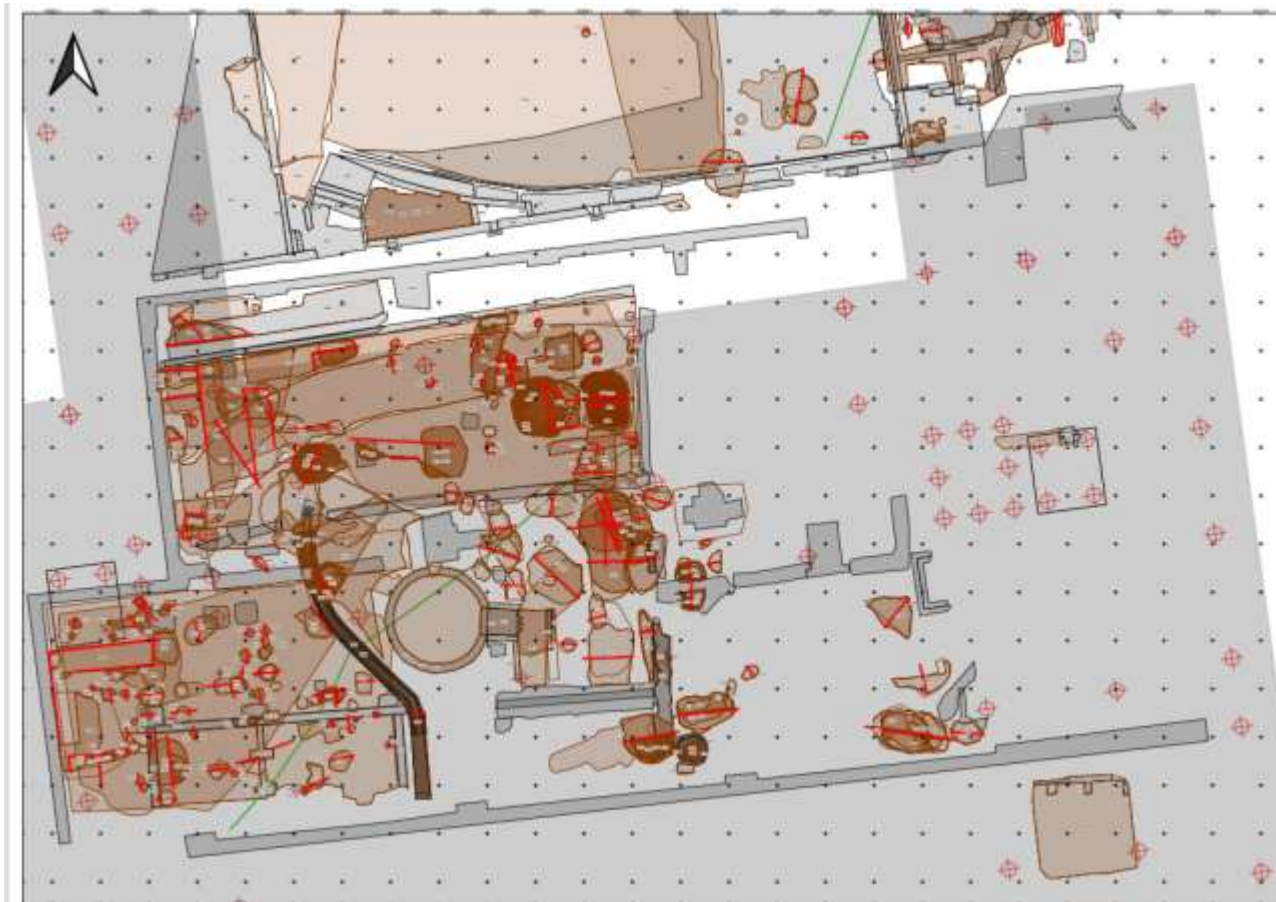

Rialto House, Fishergate: Initial Results



Initial Results: Roman Ditches



Roman flagon sherd from C4477



- Two phases of field systems
- Cobbled surface, possible remains of road identified in FAS excavations
- Plough soil

Initial Results: Anglian Pits

SF167: C4555



Anglian dated
styca -
possibly
Eanred of
Northumbria,
York Mint,
c.810–841AD



C5235

Maxey-type
(shell
tempered),
Anglian date



SF83: C5469



Initial Results: Early Medieval Pit

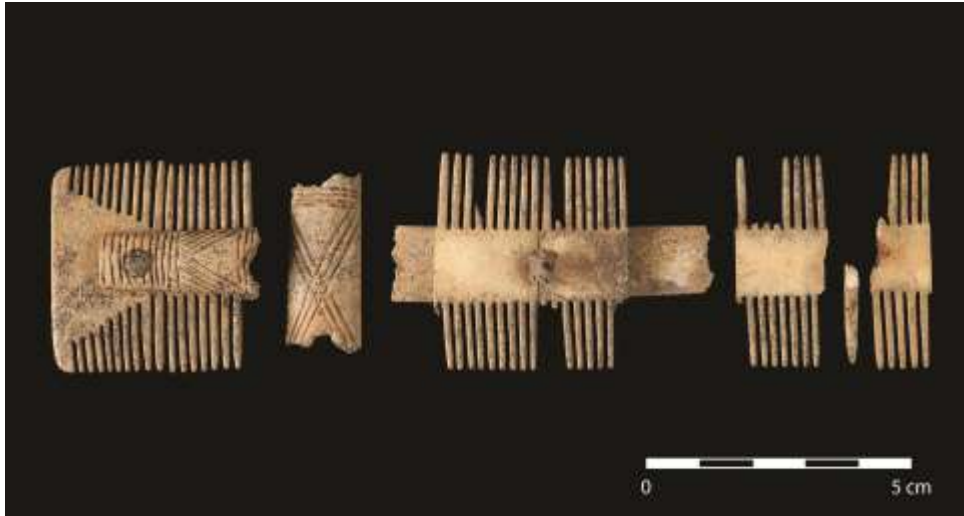

Decorated double-sided comb from pit C4781
This style are often unornamented, 6-9th century



Initial Results: Anglo-Scandinavian Pits



Anglo-Scandinavian pit C5179

Initial Results: Early Medieval



Initial Results: Medieval trackway



Initial Results: Stratigraphic Analysis



Post-built structure, south of site – 12th century or earlier construction?

Timber lined well – Roman or Anglian construction?



Initial Results: 12th – 14th century pit digging activity



Humber ware, 14th century,
C4000

Initial Results: Medieval

SF101: C4186



Stone spindle whorl
from backfill of
robbing cut

- 14th century dated soil layers observed across site
- Evidence of industrial activity
- Section of wall – robbed out in parts – Priory related?



Initial Results: Post-medieval

Freshfield Cottage related structure & ice house



1852 OS Map



Initial Results: Modern:



Initial Results: Modern



Initial Results: Rialto Cinema



Future of the Project

